

PORTABLE TRAFFIC LIGHTS



Allcott Hire
All Equipment. All For Hire. All Areas.



Designed and manufactured as a complete product by Data Signs, the DATASIGN-PTL is a very easy to use, fully solar powered Traffic Light trailer set. Featuring a revolutionary, very user-friendly, newly-designed controller as well as an electric hoist.

BUILT TO AUSTRALIAN STANDARD AS4191-1994

TRAILER SIZE: (together): 1400W x 2050H x 3620L

SHIPPING SIZE: (together): 1400W x 2050H x 2570L

SETUP SIZE, Master: 1400W x 2950H x 2030L

SETUP SIZE, Slave: 1400W x 2950H x 1580L

COMBINED WEIGHT: 700kg (with Slave Drawbar and Spare)

- 200 mm ultra-bright very low power aspects
- Solar powered, with maintenance-free battery pack for continuous operation.
- Yagi Antennas for long RF range fitted as standard.

OPTIONS:

PTL Remote, Vehicle Detectors,
Spare Wheel 240V Battery charger,
Slave Tow bar

PORTABLE TRAFFIC LIGHTS



Allcott Hire
All Equipment. All For Hire. All Areas.

OPERATIONAL CONTROL

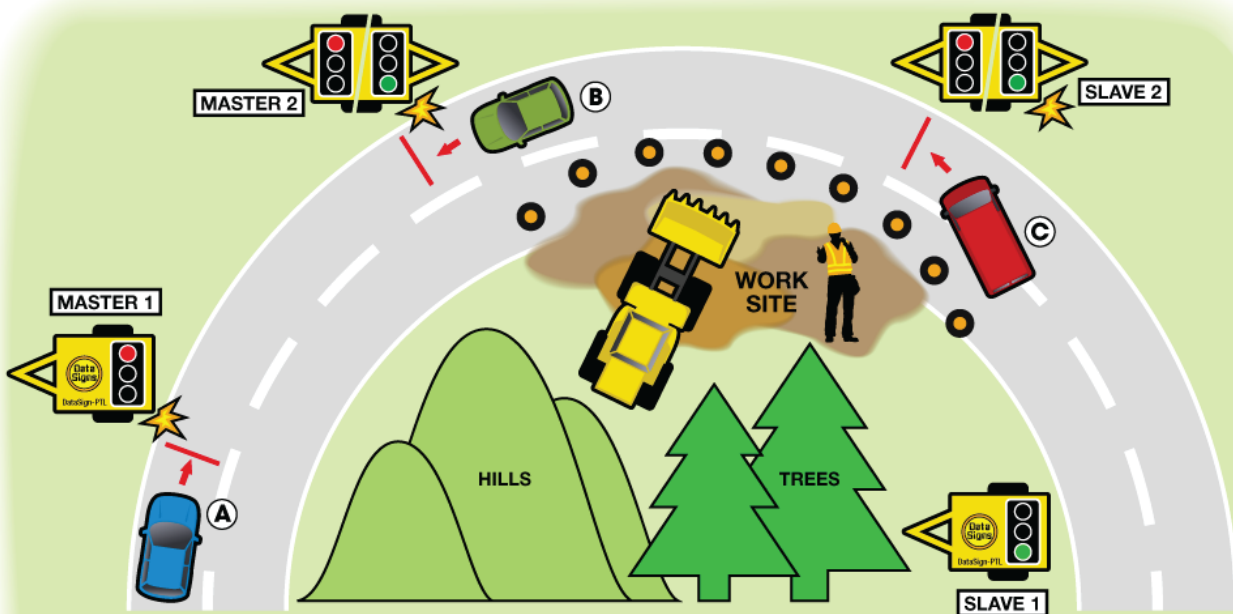
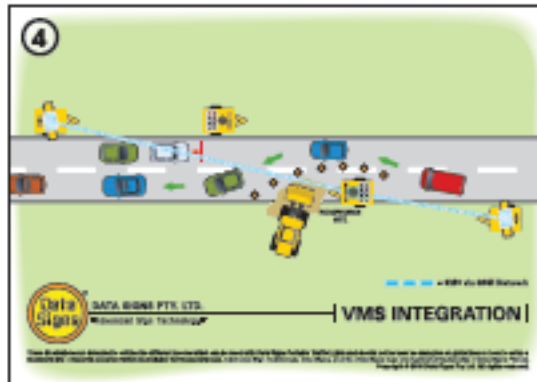
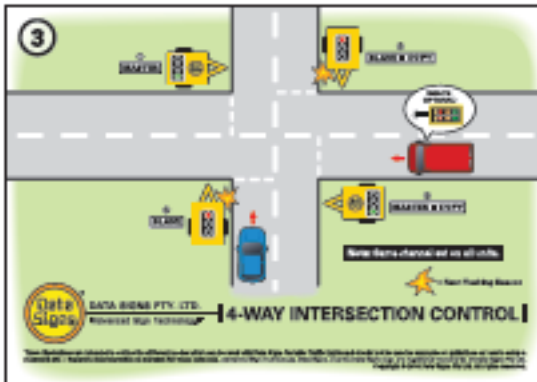
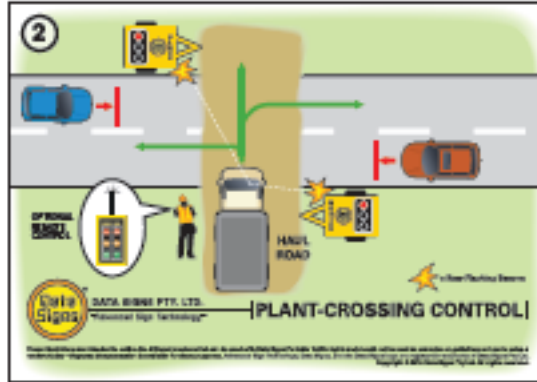
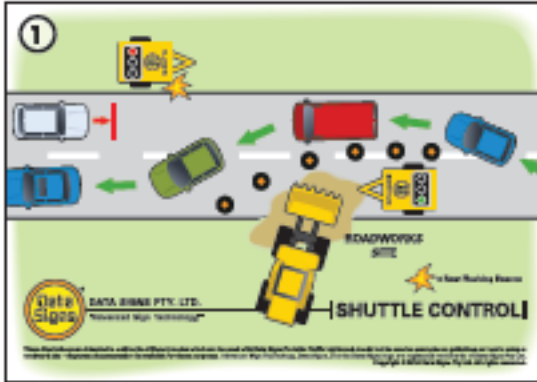

DATA SIGNS PTY. LTD.
"Advanced Sign Technology"™

PTL LINE-OF-SIGHT SETUP

If MASTER2 and SLAVE2 PTL's were not deployed:
Driver (C) cannot see the entire road work site. If MASTER1 PTL turns to Flashing Yellow, Driver (A) would proceed. However, Driver (C) would be unaware of this, and would not have time to react.

If MASTER2 and SLAVE2 PTL's were deployed:
This would provide a safe road work site for drivers. Drivers would be guided through the roadwork site as oncoming vehicles are visible and controlled in both directions.